

CAMPUSWIDE FIRE AND LIFE SAFETY UPGRADE PROJECT

The campus has completed a \$7 million Fire and Life Safety Upgrade Project started in June 2005. This project has provided CSUF with the most state of the art system of any in the CSU. All campus buildings have been upgraded except for the older Cobb Residence Halls that will be upgraded at a later date.

What is included in the Fire and Life Safety Upgrade Project?

This project includes an updated Simplex fire alarm system with improved response and reliability. Prior to the upgrade, the campus had 25 systems of different age, manufacturer and reporting ability. All future buildings will have fire alarm systems that meet the current campus standard.



Besides the electronic horn sound, a strobe light will notify occupants that a building fire alarm has been pulled or a smoke detector activated. Additionally, a voice system will be installed that provides a customized notification to occupants. University Police can override this notification with messages to single buildings or all buildings at once.

How has the fire alarm system changed?

The previous fire alarm systems reported individually to University Police either through a telephone line or through the campus network. The new system is completely on the campus fiber-optic network. University Police will continue to receive an alarm signal, but rather than a blinking light, they will see a graphic display on a computer screen showing the building floor plan, the exact location of the activated smoke detector or pull station, and obtain specific information for high hazard areas. Police and fire will be dispatched to the exact location with vital information. The standard voice message can be overridden at any time by Police to provide updated emergency information. Additionally, the Police can remotely turn on or off the alarm and give updated information to those outside the building via the Campuswide Emergency Notification system.

Other differences you might notice is the addition of strobe lights throughout the campus, and the bell or horn will be replaced by a voice annunciation system. When an alarm is activated, the voice system will first alert you with a horn followed by voice notification. A building fire alarm will also direct the elevators to the first floor unless the initiating device is on the first floor. In this case, the elevator car will be redirected to an alternate floor.

Additional improvements include:

Door Holders – Door hold-open devices are the most visible changes for employees. These holders are used to prop open doors. The intent of the device is to provide a mechanism for faculty and staff to prop open their doors without impeding the fire safety of the corridor. When the alarm is activated, the doors will automatically close. The devices will not impede exiting the room.

There are two types of door hold open devices. If you have any of the following on your office door, you have a door hold open device.



The Fire Code does not allow you to prop open your door in a fire corridor unless it can be closed by the fire alarm system. Door holders comply with this requirement and have been installed on department and employee offices opening onto a fire rated building corridor. Classrooms, workrooms, equipment rooms, laboratories, and maintenance rooms did not receive the door holders and should be kept closed if located on a fire corridor.

Some occupants, unaware of the new fire alarm system, are disabling fire alarm devices. Please be aware that this kind of behavior is illegal and ultimately could cost lives. **Anyone who tampers with or damages any portion of the fire/life safety system can be charged with vandalism - a misdemeanor. Reinstallation will be at the department's expense.**

PLEASE DO NOT:

- Remove door closures, smoke detectors, alarm, or strobes.
- Cover or block alarm/strobes, smoke detectors, or door hold-open devices.
- Block open doors with wedges.
- Use fire equipment as coat hangers.
- Smoke inside the building. If activated, the building will go into alarm.
- Place books, equipment, furniture, boxes, etc. that obstruct the operation of the door hold-open.

Campuswide Emergency Notification (ENS) – external speakers are placed outside most buildings to allow for mass notification in the event of a campuswide emergency. The speakers are grouped in zones which will allow University Police to make notification to either specific areas of campus or the entire campus. The following locations are not covered by the ENS:

Titan House	Arboretum
Sports Complex	Corp Yard
Greenhouses	Golleher House
Performing Arts Center Addition	

Fire Hydrants – an additional 29 fire hydrants have been installed to meet the current fire code requirements for hydrant placement and provide improved fire fighting coverage.

Classroom Evacuation Signs – Faculty and students often teach and attend classes in unfamiliar buildings. Classrooms now have “you are here” maps showing the emergency evacuation route and outside assembly areas for each room. Faculty should point out the signs and make students aware of major and secondary exits from each building.

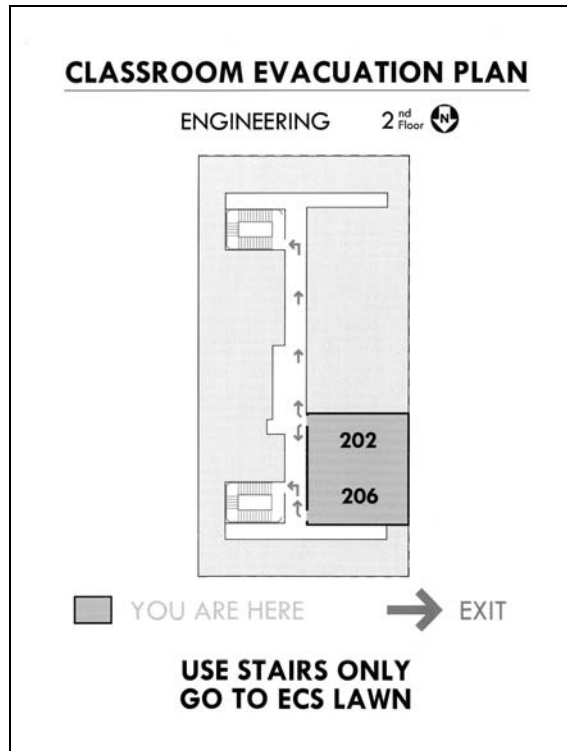

If you have any questions or comments about the new fire alarm system, please contact Tom Whitfield, Director, Environmental Health and Instructional Safety twhitfield@fullerton.edu.